

2-Slot 7/8" Directional Coupler

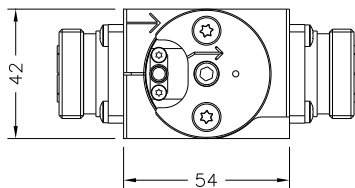
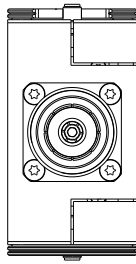
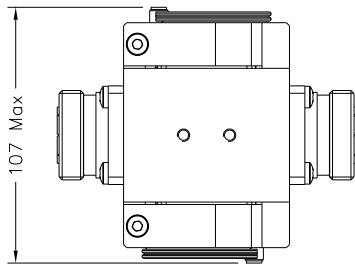
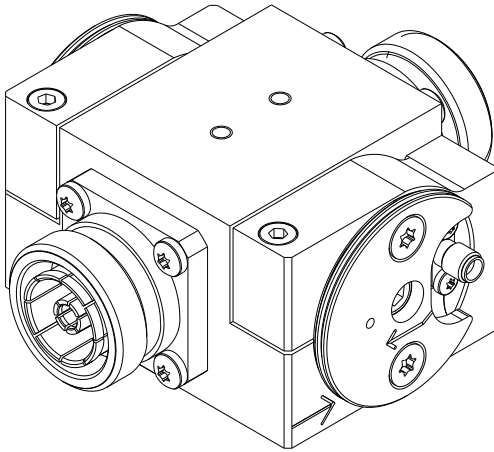

FEATURES

- *Accuprobe*: Equalized-Response Probes
- Single Accuprobe: Integrated Load; Short-Circuit Button
- Dual Accuprobe: Simultaneous FWD and RFL Meas. ⁽¹¹⁾
- SMA or N Probe Connectors
- Modular Connector System
- 10-Year Warranty

SPECIFICATIONS

Code / Revision	UHF	C-DC2A23/nC / B
	VHF B.III	C-DC2A23/nB / B
	VHF B.I	C-DC2A23/nA / B
	FM	C-DC2A23/nF / B
		<i>n</i> : Number of Probes
Frequency Range	UHF	470-862 MHz
	VHF B.III	174-240 MHz
	VHF B.I	47-100 MHz
	FM	87.5-108 MHz
Max RMS Input Power ⁽³⁾	UHF	2.7 kW (700 MHz)
	VHF B.III	4.7 kW (230 MHz)
	VHF B.I	7.6 kW (88 MHz)
	FM	6.9 kW (108 MHz)
Probe Connectors	SMA or N Female	
Reference Load	Single	2 W, Integrated
	Dual	None ⁽¹¹⁾
Max Measurement Level	32 dBm	
No. of Probes / Measures	Single	Up to 2 / Up to 2
	Dual ⁽¹¹⁾	Up to 2 / Up to 4
Coupling Ranges ⁽¹⁰⁾	UHF	-35 to -56 dB
		-51 to -68 dB (Low Coupling ⁽⁹⁾)
		-27 to -47 dB (High Coupling ⁽⁹⁾)
	VHF B.III	-35 to -55 dB
		-44 to -64 dB (Low Coupling ⁽⁹⁾)
	VHF B.I	-48 to -68 dB
	FM	-40 to -60 dB
In-Band Coupling Variation	(Nominal Coupling) ±0.2 dB	
Return Loss (VSWR)	> 34 dB (1.04)	
Directivity	Single	> 32 dB
	Dual ⁽¹¹⁾	> 26 dB
Max Operating Temperature (Body)	65 °C (149 °F)	
Environmental Conditions	-5 to +55 °C (+23 to +131 °F), IP60	
Dimensions / Weight ⁽¹⁾	54x42x107 mm / 0,6 kg	
Connectors ⁽⁸⁾	2x 32 mm	Input; Output
	D-PC32C	N Female
	D-PC32D	N Male
	D-PC32E	7-16 Female (Default)
	D-PC32F	7-16 Male
	D-PC32G	7/8" FastLine Socket
	D-PC32H	7/8" FastLine Flange
	D-PC32I	7/8" FastLine Plug
	D-PC32J	1+5/8" FastLine Socket
	D-PC32K	1+5/8" FastLine Flange
	D-PC32L	1+5/8" FastLine Plug

⁽¹⁾ Approximate, default configuration ⁽³⁾ Altitude < 1500 m (4,900 ft.), Free air, Ambient temp. < 30 °C (86 °F) ⁽⁸⁾ Other Connections available ⁽⁹⁾ Available on Single Accuprobe only
⁽¹⁰⁾ Coupling Range Steps: 0.1 dB ⁽¹¹⁾ Both measurement ports have the same coupling level, and both must be terminated, with RL≥27 dB.