

4-Slot 7/8" Directional Coupler

DC4A23

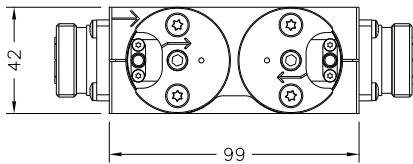
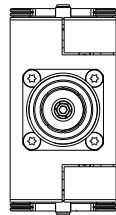
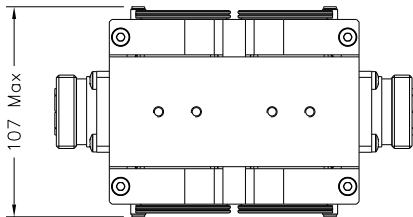
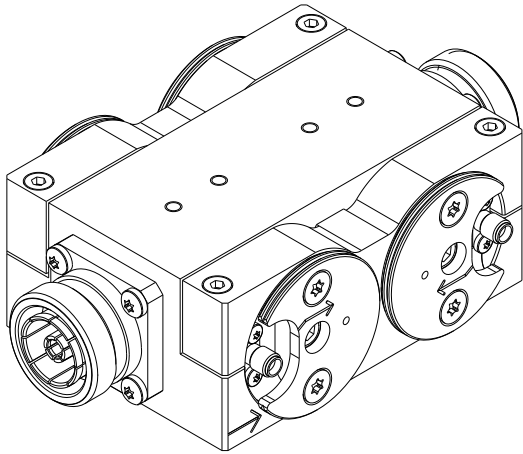

FEATURES

- *Accuprobe*: Equalized-Response Probes
- Single Accuprobe: Integrated Load; Short-Circuit Button
- Dual Accuprobe: Simultaneous FWD and RFL Meas. ⁽¹¹⁾
- SMA or N Probe Connectors
- Modular Connector System
- 10-Year Warranty

SPECIFICATIONS

Code / Revision	UHF	C-DC4A23/nC / B
	VHF B.III	C-DC4A23/nB / B
	VHF B.I	C-DC4A23/nA / B
	FM	C-DC4A23/nF / B
	<i>n: Number of Probes</i>	
Frequency Range	UHF	470-862 MHz
	VHF B.III	174-240 MHz
	VHF B.I	47-100 MHz
	FM	87.5-108 MHz
Max RMS Input Power ⁽³⁾	UHF	2.7 kW (700 MHz)
	VHF B.III	4.7 kW (230 MHz)
	VHF B.I	7.6 kW (88 MHz)
	FM	6.9 kW (108 MHz)
Probe Connectors	SMA or N Female	
Reference Load	Single	2 W, Integrated
	Dual	None ⁽¹¹⁾
Max Measurement Level	32 dBm	
No. of Probes / Measures	Single	Up to 4 / Up to 4
	Dual ⁽¹¹⁾	Up to 4 / Up to 8
Coupling Ranges ⁽¹⁰⁾	UHF	-35 to -56 dB
		-51 to -68 dB (Low Coupling ⁽⁹⁾)
		-27 to -47 dB (High Coupling ⁽⁹⁾)
	VHF B.III	-35 to -55 dB
		-44 to -64 dB (Low Coupling ⁽⁹⁾)
	VHF B.I	-48 to -68 dB
	FM	-40 to -60 dB
In-Band Coupling Variation	(Nominal Coupling) ±0.2 dB	
Return Loss (VSWR)	> 34 dB (1.04)	
Directivity	Single	> 32 dB
	Dual ⁽¹¹⁾	> 26 dB
Max Operating Temperature (Body)	65 °C (149 °F)	
Environmental Conditions	-5 to +55 °C (+23 to +131 °F), IP60	
Dimensions / Weight ⁽¹⁾	99x42x107 mm / 0,9 kg	
Connectors ⁽⁸⁾	2x 32 mm Input; Output D-PC32C N Female D-PC32D N Male D-PC32E 7-16 Female (Default) D-PC32F 7-16 Male D-PC32G 7/8" <i>FastLine</i> Socket D-PC32H 7/8" <i>FastLine</i> Flange D-PC32I 7/8" <i>FastLine</i> Plug D-PC32J 1+5/8" <i>FastLine</i> Socket D-PC32K 1+5/8" <i>FastLine</i> Flange D-PC32L 1+5/8" <i>FastLine</i> Plug	

⁽¹⁾ Approximate, default configuration ⁽³⁾ Altitude < 1500 m (4,900 ft.), Free air, Ambient temp. < 30 °C (86 °F) ⁽⁸⁾ Other Connections available ⁽⁹⁾ Available on Single Accuprobe only

⁽¹⁰⁾ Coupling Range Steps: 0.1 dB ⁽¹¹⁾ Both measurement ports have the same coupling level, and both must be terminated, with RL≥27 dB.