

100 mm Panel Connectors

3+1/8", WX-77D, NAX-77D Socket

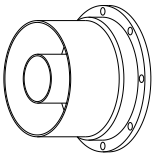

FEATURES

- Modular Connector System
- Allows Socket-Plug connections
- Zero and Recessed Cutback versions available

SPECIFICATIONS

Max RMS Power ⁽³⁾	UHF	25.0 kW	(700 MHz)
	VHF B.III	44.0 kW	(230 MHz)
	VHF B.I	71.0 kW	(88 MHz)
	FM	65.0 kW	(108 MHz)
Return Loss (VSWR)	> 40 dB (1.02)		
Environmental Conditions	-5 to +55°C (+23 to +131°F), IP60		
Mounting Screws (Included)	1 x M8x16 (6 mm Allen)		
	8 x M5x14 (4 mm Allen)		
Code	D-PC100M	3+1/8" <i>FastLine</i> Socket	
	D-PC100M1	3+1/8" Socket (17.5 mm c/back)	
	D-PC100M2	NAX-77D Socket (2 mm c/back)	
	D-PC100M4	WX-77D Socket (2 mm c/back)	

⁽³⁾ Altitude < 1500 m (4,900 ft.), Free air, Ambient temp. < 30 °C (86 °F).

3+1/8" Flange

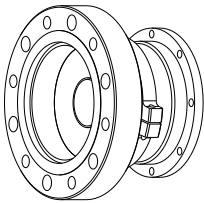

FEATURES

- Modular Connector System
- Zero and Recessed Cutback versions available

SPECIFICATIONS

Max RMS Power ⁽³⁾	UHF	25.0 kW	(700 MHz)
	VHF B.III	44.0 kW	(230 MHz)
	VHF B.I	71.0 kW	(88 MHz)
	FM	65.0 kW	(108 MHz)
Return Loss (VSWR)	> 40 dB (1.02)		
Environmental Conditions	-5 to +55°C (+23 to +131°F), IP60		
Mounting Screws (Included)	1 x M8x16 (6 mm Allen)		
	8 x M5x14 (4 mm Allen)		
Code ⁽¹⁴⁾	D-PC100N	3+1/8" <i>FastLine</i> Flange	
	D-PC100N1	3+1/8" Flange (17.5 mm c/back)	
Options	O-NNB.03	3+1/8" Flange coupling screws kit	

⁽³⁾ Altitude < 1500 m (4,900 ft.), Free air, Ambient temp. < 30 °C (86 °F)

⁽¹⁴⁾ Inner Connections not included

3+1/8", WX-77D, NAX-77D Plug

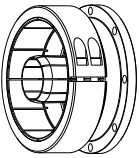

FEATURES

- Modular Connector System
- Allows Socket-Plug connections
- Zero and Recessed Cutback versions available

SPECIFICATIONS

Max RMS Power ⁽³⁾	UHF	25.0 kW	(700 MHz)
	VHF B.III	44.0 kW	(230 MHz)
	VHF B.I	71.0 kW	(88 MHz)
	FM	65.0 kW	(108 MHz)
Return Loss (VSWR)	> 40 dB (1.02)		
Environmental Conditions	-5 to +55°C (+23 to +131°F), IP60		
Mounting Screws (Included)	1 x M8x16 (6 mm Allen)		
	8 x M5x14 (4 mm Allen)		
Code	D-PC100O	3+1/8" <i>FastLine</i> Plug	
	D-PC100O1	3+1/8" Plug (17.5 mm c/back)	
	D-PC100O2	NAX-77D Plug (2 mm c/back)	
	D-PC100O4	WX-77D Plug (2 mm c/back)	

⁽³⁾ Altitude < 1500 m (4,900 ft.), Free air, Ambient temp. < 30 °C (86 °F).

4+1/2" Socket

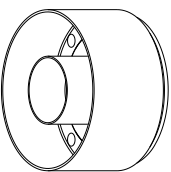

FEATURES

- Modular Connector System
- Allows Socket-Plug connections

SPECIFICATIONS

Max RMS Power ⁽³⁾	UHF	37.0 kW	(700 MHz)
	VHF B.III	65.0 kW	(230 MHz)
	VHF B.I	105.0 kW	(88 MHz)
	FM	95.0 kW	(108 MHz)
Return Loss (VSWR)	> 40 dB (1.02)		
Environmental Conditions	-5 to +55°C (+23 to +131°F), IP60		
Mounting Screws (Included)	1 x M8x16 (6 mm Allen)		
	8 x M5x14 (4 mm Allen)		
Code	D-PC100P	4+1/2" <i>FastLine</i> Socket	

⁽³⁾ Altitude < 1500 m (4,900 ft.), Free air, Ambient temp. < 30 °C (86 °F).

100 mm Panel Connectors

PC100

4+1/2" Flange

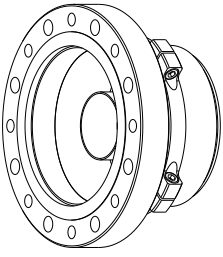

FEATURES

- Modular Connector System

SPECIFICATIONS

Max RMS Power ⁽³⁾	UHF	37.0 kW	(700 MHz)
	VHF B.III	65.0 kW	(230 MHz)
	VHF B.I	105.0 kW	(88 MHz)
	FM	95.0 kW	(108 MHz)
Return Loss (VSWR)	> 40 dB (1.02)		
Environmental Conditions	-5 to +55°C (+23 to +131°F), IP60		
Mounting Screws (Included)	1 x M8x16 (6 mm Allen)		
	8 x M5x14 (4 mm Allen)		
Code ⁽¹⁴⁾	D-PC100Q	4+1/2" <i>FastLine</i> Flange	
Options	O-NNB.04	4+1/2" Flange coupling screws kit	
⁽³⁾ Altitude < 1500 m (4,900 ft.), Free air, Ambient temp. < 30 °C (86 °F)			
⁽¹⁴⁾ Inner Connections not included			