

## 130 mm Panel Connectors

## 4+1/2", WX-103D, 4+1/16" Socket

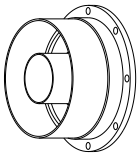

## FEATURES

- Modular Connector System
- Allows Socket-Plug connections
- Zero and Recessed Cutback versions available

## SPECIFICATIONS

Max RMS Power <sup>(3)</sup>		4+1/2"	4+1/16"	
	UHF	37.0 kW	35.0 kW	(700 MHz)
	VHF B.III	65.0 kW	61.0 kW	(230 MHz)
	VHF B.I	105.0 kW	99.0 kW	(88 MHz)
	FM	95.0 kW	89.0 kW	(108 MHz)
Return Loss (VSWR)	> 40 dB (1.02)			
Environmental Conditions	-5 to +55°C (+23 to +131°F), IP60			
Mounting Screws (Included)	1 x M10x20 (8 mm Allen)			
	8 x M6x16 (5 mm Allen)			
Code	D-PC130P	4+1/2" <i>FastLine</i> Socket		
	D-PC130P2	WX-103D Socket (3 mm c/back)		
	D-PC130P6	4+1/16" <i>FastLine</i> Socket		

<sup>(3)</sup> Altitude < 1500 m (4,900 ft.), Free air, Ambient temp. < 30 °C (86 °F),

## 4+1/2", 4+1/16" Flange

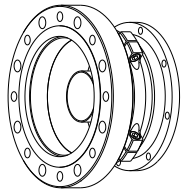

## FEATURES

- Modular Connector System

## SPECIFICATIONS

Max RMS Power <sup>(3)</sup>		4+1/2"	4+1/16"	
	UHF	37.0 kW	35.0 kW	(700 MHz)
	VHF B.III	65.0 kW	61.0 kW	(230 MHz)
	VHF B.I	105.0 kW	99.0 kW	(88 MHz)
	FM	95.0 kW	89.0 kW	(108 MHz)
Return Loss (VSWR)	> 40 dB (1.02)			
Environmental Conditions	-5 to +55°C (+23 to +131°F), IP60			
Mounting Screws (Included)	1 x M10x20 (8 mm Allen)			
	8 x M6x16 (5 mm Allen)			
Code <sup>(14)</sup>	D-PC130Q	4+1/2" <i>FastLine</i> Flange		
	D-PC130Q6	4+1/16" <i>FastLine</i> Flange		
Options	O-NNB.04	4+1/2" Flange coupling screws kit		

<sup>(3)</sup> Altitude < 1500 m (4,900 ft.), Free air, Ambient temp. < 30 °C (86 °F)

<sup>(14)</sup> Inner Connections not included

## 4+1/2" Plug

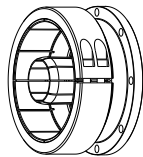

## FEATURES

- Modular Connector System
- Allows Socket-Plug connections

## SPECIFICATIONS

Max RMS Power <sup>(3)</sup>	UHF	37.0 kW	(700 MHz)
	VHF B.III	65.0 kW	(230 MHz)
	VHF B.I	105.0 kW	(88 MHz)
	FM	95.0 kW	(108 MHz)
	Return Loss (VSWR)	> 40 dB (1.02)	
Environmental Conditions	-5 to +55°C (+23 to +131°F), IP60		
Mounting Screws (Included)	1 x M10x20 (8 mm Allen)		
	8 x M6x16 (5 mm Allen)		
Code	D-PC130R	4+1/2" <i>FastLine</i> Plug	
Options	O-NB.04	4+1/2" Flange coupling screws kit	

<sup>(3)</sup> Altitude < 1500 m (4,900 ft.), Free air, Ambient temp. < 30 °C (86 °F),

## RL-120 Socket

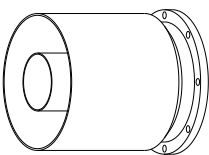

## FEATURES

- Modular Connector System
- Allows Socket-Plug connections

## SPECIFICATIONS

Max RMS Power <sup>(3)</sup>	UHF	48.0 kW	(700 MHz)
	VHF B.III	83.0 kW	(230 MHz)
	VHF B.I	134.0 kW	(88 MHz)
	FM	121.0 kW	(108 MHz)
	Return Loss (VSWR)	> 40 dB (1.02)	
Environmental Conditions	-5 to +55°C (+23 to +131°F), IP60		
Mounting Screws (Included)	1 x M10x20 (8 mm Allen)		
	8 x M6x16 (5 mm Allen)		
Code	D-PC130S	RL-120 <i>FastLine</i> Socket	

<sup>(3)</sup> Altitude < 1500 m (4,900 ft.), Free air, Ambient temp. < 30 °C (86 °F),

## 130 mm Panel Connectors

PC130

## RL-120 Flange

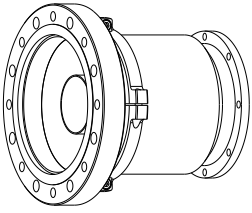

## FEATURES

- Modular Connector System

## SPECIFICATIONS

Max RMS Power <sup>(3)</sup>	UHF	48.0 kW	(700 MHz)
	VHF B.III	83.0 kW	(230 MHz)
	VHF B.I	134.0 kW	(88 MHz)
	FM	121.0 kW	(108 MHz)
Return Loss (VSWR)	> 40 dB (1.02)		
Environmental Conditions	-5 to +55°C (+23 to +131°F), IP60		
Mounting Screws (Included)	1 x M10x20 (8 mm Allen)		
	8 x M6x16 (5 mm Allen)		
Code <sup>(14)</sup>	D-PC130X	RL-120 <i>FastLine</i> Flange	
Options	O-NNB.06	RL-120 Flange coupling screws kit	
<sup>(3)</sup> Altitude < 1500 m (4.900 ft.), Free air, Ambient temp. < 30 °C (86 °F)			
<sup>(14)</sup> Inner Connections not included			