

150 mm Panel Connectors

RL-120 Socket

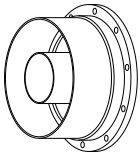

FEATURES

- Modular Connector System
- Allows Socket-Plug connections

SPECIFICATIONS

Max RMS Power ⁽³⁾	UHF	48.0 kW	(700 MHz)
	VHF B.III	83.0 kW	(230 MHz)
	VHF B.I	134.0 kW	(88 MHz)
	FM	121.0 kW	(108 MHz)

Return Loss (VSWR)	> 40 dB (1.02)
--------------------	----------------

Environmental Conditions	-5 to +55°C (+23 to +131°F), IP60
--------------------------	-----------------------------------

Mounting Screws (Included)	1 x M12x20 (10 mm Allen)
	10 x M6x16 (5 mm Allen)

Code	D-PC150S	RL-120 <i>FastLine</i> Socket
------	----------	-------------------------------

⁽³⁾ Altitude < 1500 m (4,900 ft.), Free air, Ambient temp. < 30 °C (86 °F).

RL-120 Flange

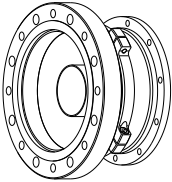

FEATURES

- Modular Connector System

SPECIFICATIONS

Max RMS Power ⁽³⁾	UHF	48.0 kW	(700 MHz)
	VHF B.III	83.0 kW	(230 MHz)
	VHF B.I	134.0 kW	(88 MHz)
	FM	121.0 kW	(108 MHz)

Return Loss (VSWR)	> 40 dB (1.02)
--------------------	----------------

Environmental Conditions	-5 to +55°C (+23 to +131°F), IP60
--------------------------	-----------------------------------

Mounting Screws (Included)	1 x M12x20 (10 mm Allen)
	10 x M6x16 (5 mm Allen)

Code ⁽¹⁴⁾	D-PC150X	RL-120 <i>FastLine</i> Flange
----------------------	----------	-------------------------------

Options	O-NNB.06	RL-120 Flange coupling screws kit
---------	----------	-----------------------------------

⁽³⁾ Altitude < 1500 m (4,900 ft.), Free air, Ambient temp. < 30 °C (86 °F)

⁽¹⁴⁾ Inner Connections not included

RL-120 Plug

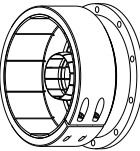

FEATURES

- Modular Connector System
- Allows Socket-Plug connections

SPECIFICATIONS

Max RMS Power ⁽³⁾	UHF	48.0 kW	(700 MHz)
	VHF B.III	83.0 kW	(230 MHz)
	VHF B.I	134.0 kW	(88 MHz)
	FM	121.0 kW	(108 MHz)

Return Loss (VSWR)	> 40 dB (1.02)
--------------------	----------------

Environmental Conditions	-5 to +55°C (+23 to +131°F), IP60
--------------------------	-----------------------------------

Mounting Screws (Included)	1 x M12x20 (10 mm Allen)
	10 x M6x16 (5 mm Allen)

Code	D-PC150T	RL-120 <i>FastLine</i> Plug
------	----------	-----------------------------

⁽³⁾ Altitude < 1500 m (4,900 ft.), Free air, Ambient temp. < 30 °C (86 °F).

6+1/8" Socket

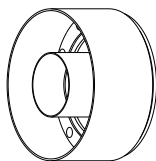

FEATURES

- Modular Connector System
- Allows Socket-Plug connections

SPECIFICATIONS

Max RMS Power ⁽³⁾	UHF	74.0 kW	(700 MHz)
	VHF B.III	130.0 kW	(230 MHz)
	VHF B.I	210.0 kW	(88 MHz)
	FM	189.0 kW	(108 MHz)

Return Loss (VSWR)	> 40 dB (1.02)
--------------------	----------------

Environmental Conditions	-5 to +55°C (+23 to +131°F), IP60
--------------------------	-----------------------------------

Mounting Screws (Included)	1 x M12x20 (10 mm Allen)
	10 x M6x16 (5 mm Allen)

Code	D-PC150U	6+1/8" <i>FastLine</i> Socket
------	----------	-------------------------------

⁽³⁾ Altitude < 1500 m (4,900 ft.), Free air, Ambient temp. < 30 °C (86 °F).

150 mm Panel Connectors

6+1/8" Flange

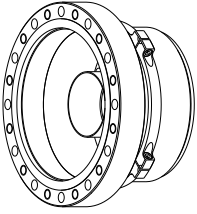

FEATURES

- Modular Connector System
- Zero and Recessed Cutback versions available

SPECIFICATIONS

Max RMS Power ⁽³⁾	UHF	74.0 kW	(700 MHz)
	VHF B.III	130.0 kW	(230 MHz)
	VHF B.I	210.0 kW	(88 MHz)
	FM	189.0 kW	(108 MHz)
Return Loss (VSWR)	> 40 dB (1.02)		
Environmental Conditions	-5 to +55°C (+23 to +131°F), IP60		
Mounting Screws (Included)	1 x M12x20 (10 mm Allen)		
	10 x M6x16 (5 mm Allen)		
Code ⁽¹⁴⁾	D-PC150V 6+1/8" <i>FastLine</i> Flange		
Options	O-NNB.05 6+1/8" Flange coupling screws kit		
⁽³⁾ Altitude < 1500 m (4.900 ft.), Free air, Ambient temp. < 30 °C (86 °F)			
⁽¹⁴⁾ Inner Connections not included			

6+1/8" Plug

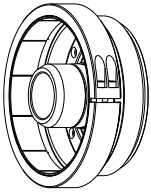

FEATURES

- Modular Connector System
- Allows Socket-Plug connections

SPECIFICATIONS

Max RMS Power ⁽³⁾	UHF	74.0 kW	(700 MHz)
	VHF B.III	130.0 kW	(230 MHz)
	VHF B.I	210.0 kW	(88 MHz)
	FM	189.0 kW	(108 MHz)
Return Loss (VSWR)	> 40 dB (1.02)		
Environmental Conditions	-5 to +55°C (+23 to +131°F), IP60		
Mounting Screws (Included)	1 x M12x20 (10 mm Allen)		
	10 x M6x16 (5 mm Allen)		
Code	D-PC150W 6+1/8" <i>FastLine</i> Plug		
⁽³⁾ Altitude < 1500 m (4.900 ft.), Free air, Ambient temp. < 30 °C (86 °F),			