

32 mm Panel Connectors

N Female

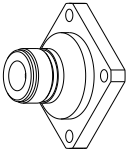

FEATURES

- Modular Connector System

SPECIFICATIONS

Max RMS Power ⁽³⁾	UHF	500 W	(700 MHz)
	VHF B.III	900 W	(230 MHz)
	VHF B.I	1.4 kW	(88 MHz)
	FM	1.3 kW	(108 MHz)
Environmental Conditions	-5 to +55°C (+23 to +131°F), IP60		
Mounting Screws (Included)	4 x M3.5x10 (Tx15 Torx)		
Code	D-PC32C N Female		

⁽³⁾ Altitude < 1500 m (4.900 ft.), Free air, Ambient temp. < 30 °C (86 °F)

N Male

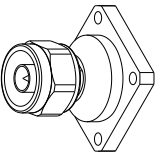

FEATURES

- Modular Connector System

SPECIFICATIONS

Max RMS Power ⁽³⁾	UHF	500 W	(700 MHz)
	VHF B.III	900 W	(230 MHz)
	VHF B.I	1.4 kW	(88 MHz)
	FM	1.3 kW	(108 MHz)
Environmental Conditions	-5 to +55°C (+23 to +131°F), IP60		
Mounting Screws (Included)	4 x M3.5x10 (Tx15 Torx)		
Code	D-PC32D Male		

⁽³⁾ Altitude < 1500 m (4.900 ft.), Free air, Ambient temp. < 30 °C (86 °F)

7-16 Female

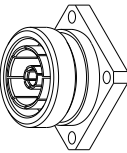

FEATURES

- Modular Connector System

SPECIFICATIONS

Max RMS Power ⁽³⁾	UHF	2.0 kW	(700 MHz)
	VHF B.III	3.5 kW	(230 MHz)
	VHF B.I	5.6 kW	(88 MHz)
	FM	5.1 kW	(108 MHz)

SPECIFICATIONS

Return Loss (VSWR)	> 40 dB (1.02)		
Environmental Conditions	-5 to +55°C (+23 to +131°F), IP60		
Mounting Screws (Included)	4 x M3.5x10 (Tx15 Torx)		
Code	D-PC32E 7-16 Female		
	D-PC32E1 7-16 Female, Precision		

⁽³⁾ Altitude < 1500 m (4.900 ft.), Free air, Ambient temp. < 30 °C (86 °F)

7-16 Male

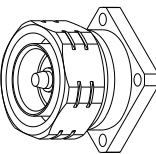

FEATURES

- Modular Connector System

SPECIFICATIONS

Max RMS Power ⁽³⁾	UHF	2.0 kW	(700 MHz)
	VHF B.III	3.5 kW	(230 MHz)
	VHF B.I	5.6 kW	(88 MHz)
	FM	5.1 kW	(108 MHz)

Return Loss (VSWR)	> 40 dB (1.02)		
Environmental Conditions	-5 to +55°C (+23 to +131°F), IP60		
Mounting Screws (Included)	4 x M3.5x10 (Tx15 Torx)		
Code	D-PC32F 7-16 Male		

⁽³⁾ Altitude < 1500 m (4.900 ft.), Free air, Ambient temp. < 30 °C (86 °F)

32 mm Panel Connectors

7/8", WX20D Socket

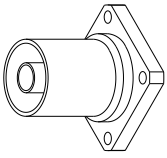

FEATURES

- Modular Connector System
- Allows Socket-Plug connections
- Zero and Recessed Cutback versions available

SPECIFICATIONS

Max RMS Power ⁽³⁾	UHF	2.7 kW	(700 MHz)
	VHF B.III	4.7 kW	(230 MHz)
	VHF B.I	7.6 kW	(88 MHz)
	FM	6.9 kW	(108 MHz)
Return Loss (VSWR)	> 40 dB (1.02)		
Environmental Conditions	-5 to +55°C (+23 to +131°F), IP60		
Mounting Screws (Included)	4 x M3.5x10 (Tx15 Torx)		
Code	D-PC32G	7/8" <i>FastLine</i> Socket	
	D-PC32G1	7/8" Socket (8.7 mm c/back)	
	D-PC32G2	WX-20D Socket (1 mm c/back)	

⁽³⁾ Altitude < 1500 m (4,900 ft.), Free air, Ambient temp. < 30 °C (86 °F),

7/8" Flange

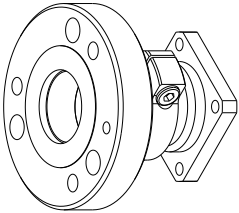

FEATURES

- Modular Connector System
- Zero and Recessed Cutback versions available

SPECIFICATIONS

Max RMS Power ⁽³⁾	UHF	2.7 kW	(700 MHz)
	VHF B.III	4.7 kW	(230 MHz)
	VHF B.I	7.6 kW	(88 MHz)
	FM	6.9 kW	(108 MHz)
Return Loss (VSWR)	> 40 dB (1.02)		
Environmental Conditions	-5 to +55°C (+23 to +131°F), IP60		
Mounting Screws (Included)	4 x M3.5x10 (Tx15 Torx)		
Code ⁽¹⁴⁾	D-PC32H	7/8" <i>FastLine</i> Flange	
	D-PC32H1	7/8" Flange(8.7 mm c/back)	
Options	O-NNB.01		

⁽³⁾ Altitude < 1500 m (4,900 ft.), Free air, Ambient temp. < 30 °C (86 °F)

⁽¹⁴⁾ Inner Connections not included

7/8", WX-20D Plug; 7/8" Quick Plug



FEATURES

- Modular Connector System
- Allows Socket-Plug connections
- Zero and Recessed Cutback versions available

SPECIFICATIONS

Max RMS Power ⁽³⁾	UHF	2.7 kW	(700 MHz)
	VHF B.III	4.7 kW	(230 MHz)
	VHF B.I	7.6 kW	(88 MHz)
	FM	6.9 kW	(108 MHz)
Return Loss (VSWR)	> 40 dB (1.02)		
Environmental Conditions	-5 to +55°C (+23 to +131°F), IP60		
Mounting Screws (Included)	4 x M3.5x10 (Tx15 Torx)		
Code	D-PC32I	7/8" <i>FastLine</i> Plug	
	D-PC32I0	7/8" <i>FastLine</i> Quick Plug	
	D-PC32I1	7/8" Plug (8.7 mm c/back)	
	D-PC32I2	WX-20D Plug (1 mm c/back)	

⁽³⁾ Altitude < 1500 m (4,900 ft.), Free air, Ambient temp. < 30 °C (86)

1+5/8", WX-39D Socket

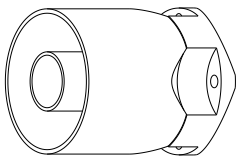

FEATURES

- Modular Connector System
- Allows Socket-Plug connections
- Zero and Recessed Cutback versions available

SPECIFICATIONS

Max RMS Power ⁽³⁾	UHF	4.9 kW	(700 MHz)
	VHF B.III	8.5 kW	(230 MHz)
	VHF B.I	13.7 kW	(88 MHz)
	FM	12.4 kW	(108 MHz)
Return Loss (VSWR)	> 40 dB (1.02)		
Environmental Conditions	-5 to +55°C (+23 to +131°F), IP60		
Mounting Screws (Included)	4 x M3.5x10 (Tx15 Torx)		
Code	D-PC32J	1+5/8" <i>FastLine</i> Socket	
	D-PC32J1	1+5/8" Socket (11.1 mm c/back)	
	D-PC32J2	WX-39D Socket (1.5 mm c/back)	

⁽³⁾ Altitude < 1500 m (4,900 ft.), Free air, Ambient temp. < 30 °C (86)

32 mm Panel Connectors

1+5/8" Flange

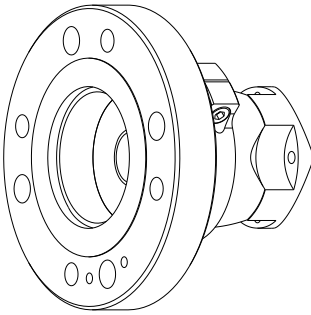

FEATURES

- Modular Connector System
- Zero and Recessed Cutback versions available

SPECIFICATIONS

Max RMS Power ⁽³⁾	UHF	4.9 kW	(700 MHz)
	VHF B.III	8.5 kW	(230 MHz)
	VHF B.I	13.7 kW	(88 MHz)
	FM	12.4 kW	(108 MHz)
Return Loss (VSWR)	> 40 dB (1.02)		
Environmental Conditions	-5 to +55°C (+23 to +131°F), IP60		
Mounting Screws (Included)	4 x M3.5x10 (Tx15 Torx)		
Code ⁽¹⁴⁾	D-PC32K	1+5/8" <i>FastLine</i> Flange	
	D-PC32K1	1+5/8" Flange (11.1 mm c/back)	
Options	O-NNB.02	1+5/8" Flange coupling screws kit	

⁽³⁾ Altitude < 1500 m (4,900 ft.), Free air, Ambient temp. < 30 °C (86 °F)

⁽¹⁴⁾ Inner Connections not included

1+5/8" Plug

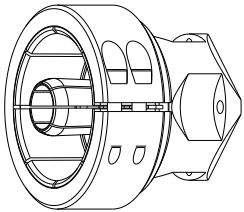

FEATURES

- Modular Connector System
- Allows Socket-Plug connections

SPECIFICATIONS

Max RMS Power ⁽³⁾	UHF	4.9 kW	(700 MHz)
	VHF B.III	8.5 kW	(230 MHz)
	VHF B.I	13.7 kW	(88 MHz)
	FM	12.4 kW	(108 MHz)
Return Loss (VSWR)	> 40 dB (1.02)		
Environmental Conditions	-5 to +55°C (+23 to +131°F), IP60		
Mounting Screws (Included)	4 x M3.5x10 (Tx15 Torx)		
Code	D-PC32L	1 + 5/8" <i>FastLine</i> Plug	

⁽³⁾ Altitude < 1500 m (4,900 ft.), Free air, Ambient temp. < 30 °C (86 °F)

⁽¹⁴⁾ Inner Connections not included