

32 mm Straight Adapters

SC32

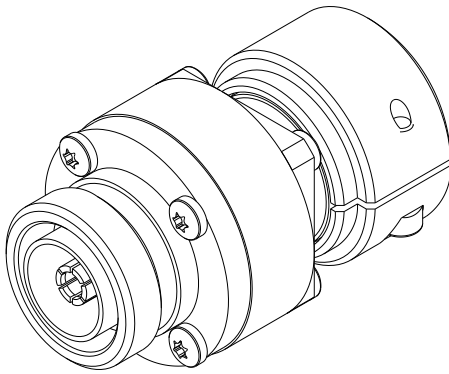

FEATURES

- Interchangeable Connector System
- *FastLine* System
- Flush, Recessed and NAX/WX Cutbacks
- Direct Socket-Plug Connections
- EIA and JEITA Standard Compatible

N, 7-16, 7/8" (WX-20D) to
N, 7-16, 7/8" (WX-20D)



SPECIFICATIONS

Code / Revision	D-SC32 / A
Return Loss ⁽¹⁾	> 40 dB (VSWR < 1.02)
Environmental Conditions	-5 to +55°C (+23 to +131°F), IP60
Connection A ⁽²⁾	N Female / Male 7-16 Female / Male 7/8" (WX-20D) Socket / Flange / Plug
Connection B ⁽²⁾	N Female / Male 7-16 Female / Male 7/8" (WX-20D) Socket / Flange / Plug
Options ⁽³⁾	Flange nuts and bolts set

⁽¹⁾ @ 800 MHz ⁽²⁾ Inner Connections not included (Flanges only) ⁽³⁾ Flanges only