

# PANEL CONNECTORS

100 mm Series

PC100x

## PC100M

EIA 3+1/8" *FastLine* SOCKET

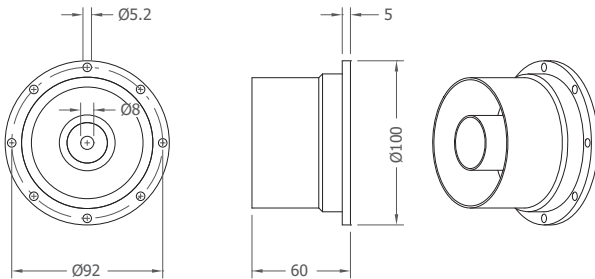

**100**  
mm  
Connectors

### SPECIFICATIONS

Frequency Range	0 – 1 GHz
Return Loss	>40 dB (VSWR < 1.02)

## PC100N

EIA 3+1/8" *FastLine* FLANGE

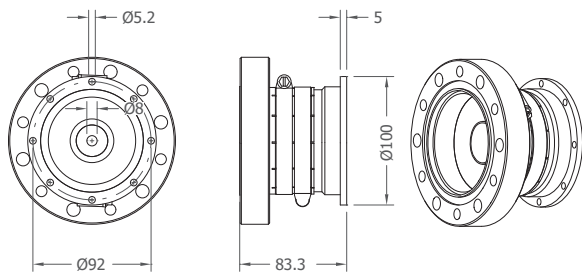

**100**  
mm  
Connectors

### SPECIFICATIONS

Frequency Range	0 – 1 GHz
Return Loss	>40 dB (VSWR < 1.02)

## PC100O

EIA 3+1/8" *FastLine* PLUG

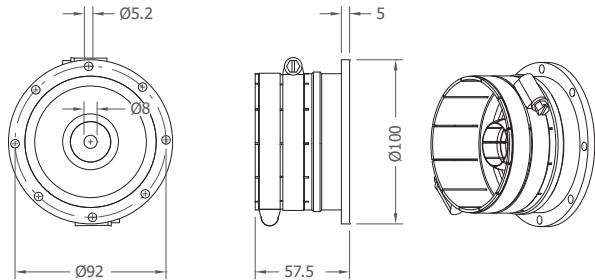

**100**  
mm  
Connectors

### SPECIFICATIONS

Frequency Range	0 – 1 GHz
Return Loss	>40 dB (VSWR < 1.02)

## PC100P

EIA 4+1/2" *FastLine* SOCKET

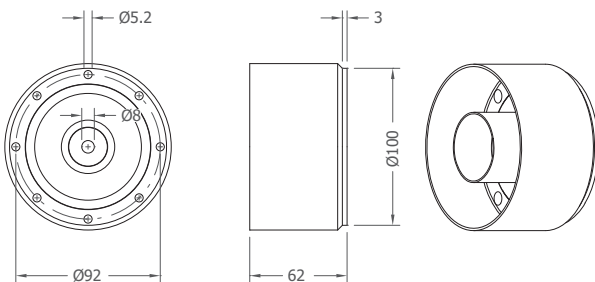

**100**  
mm  
Connectors

### SPECIFICATIONS

Frequency Range	0 – 1 GHz
Return Loss	>40 dB (VSWR < 1.02)

## PC100Q

EIA 4+1/2" *FastLine* FLANGE

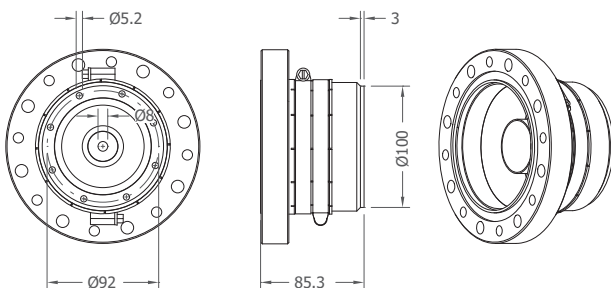

**100**  
mm  
Connectors

### SPECIFICATIONS

Frequency Range	0 – 1 GHz
Return Loss	>40 dB (VSWR < 1.02)

**AC100**

ANGULAR CONNECTION

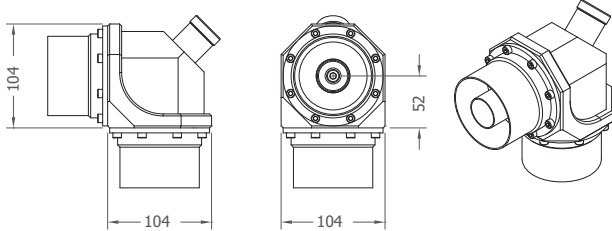

**100**  
mm  
Connectors

**SPECIFICATIONS**

Product Code	D-AC100-xx-yy
Frequency Range	0 – 1 GHz
Return Loss	>40 dB (VSWR < 1.02)
Connectors	D-PC100M EIA 3+1/8" FastLine Socket D-PC100N EIA 3+1/8" FastLine Flange D-PC100O EIA 3+1/8" FastLine Plug

**SC100**

STRAIGHT CONNECTION

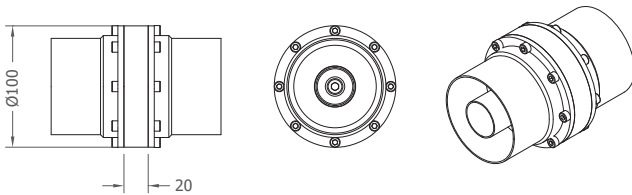

**100**  
mm  
Connectors

**SPECIFICATIONS**

Product Code	D-SC100-xx-yy
Frequency Range	0 – 1 GHz
Return Loss	>40 dB (VSWR < 1.02)
Connectors	D-PC100C N Female D-PC100D N Male D-PC100E 7-16 Female D-PC100F 7-16 Male D-PC100G EIA 7/8" FastLine Socket D-PC100H EIA 7/8" FastLine Flange D-PC100I EIA 7/8" FastLine Plug D-PC100J EIA 1+5/8" FastLine Socket D-PC100K EIA 1+5/8" FastLine Flange D-PC100L EIA 1+5/8" FastLine Plug D-PC100M EIA 3+1/8" FastLine Socket D-PC100N EIA 3+1/8" FastLine Flange D-PC100O EIA 3+1/8" FastLine Plug