

UHF (800 MHz) 1+5/8" Lowpass Filter

LP39RC

FEATURES

- 800 MHz Cut-Off
- 5G n1-n76 Protection
- Rigid Line Interface
- 10-Year Warranty

OPTIONS

- Flanges

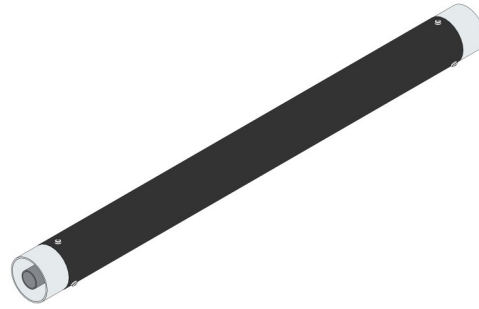

SPECIFICATIONS

Code / Revision	A-LP39RC / A	
Lowpass Band	470-800 MHz	
No. of Poles	15-Pole	
Max RMS Input Power ⁽³⁾	2.1 kW	(700 MHz)
	1.3 kW	(800 MHz)
Insertion Loss	< 0.05 dB (800 MHz)	
Return Loss (VSWR)	> 30 dB (1.07)	
Selectivity	> 29 dB (940 to 2600 MHz)	
Max Operating Temperature (Body)	65 °C (149 °F)	
Environmental Conditions	-5 to +55 °C (+23 to +131 °F), IP60	
Dimensions / Weight ⁽¹⁾	503 mm, 1+5/8" / 0.6 kg	
Interface	1+5/8" Rigid Line	
Options	O-TLP39.01 1+5/8" <i>FastLine</i> Flange	

⁽¹⁾ Approximate, default configuration ⁽³⁾ Altitude < 1500 m (4,900 ft.), Free air, Ambient temp. < 30 °C (86 °F)